

Electro magnetic flow meter



Output:4-20mA,pulse/frequency output (active)
 Accuracy:±0.5%,±1%
 Power supply:220VAC (50HZ or 60HZ) /24VDC
 Measure direction: forward/reverse
 Environment condition:temp.-25°C-60°C,relative humidity 90%
 Display:7 numbers of instantaneous delivery,8 numbers of totalizer
 Computed mode: 4 keys
 Dimensions:132*132*95mm
 Installation:compact

Diameter:DN10mm-DN2000mm

Electrodes:316L,Hb,Hc,Ti,Ta,Pt

Liner:rubber,polyurethane,PTFE,PFA,F46

Medium:conductivity liquids

Medium conductivity:≥5μs/cm ,soften water≥20μs/cm

Accuracy:±0.5%RS-±1.0%RS

Velocity of flow:0.1m/s-10m/s

Working temp.:compact≤120°C,remote≤150°C(rubber≤65°C)

Working pressure:0.6Mpa-4.0Mpa(base on diameter)

Protection class:IP65,IP67,IP68(remote type)

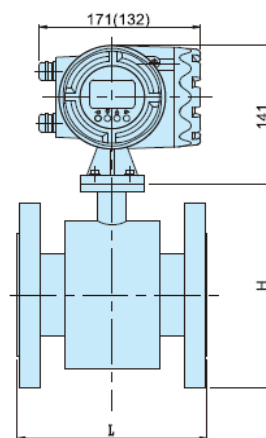
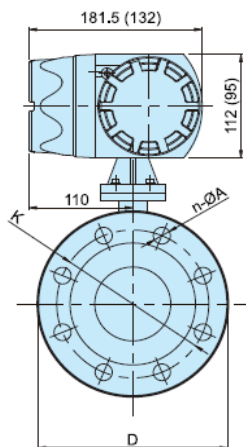

יונייטד מכשור בע"מ

מד זרימה מגנטי 70 – UUL

DN mm		Max working pressure (MPa)	L	D	K	n-øA	Compact W/G(KG)
10	3/8"	4.0	150	90	60	4-ø14	8
15	1/2"		150	95	65	4-ø14	8
20	3/4"		150	105	75	4-ø14	8
25	1"		150	115	85	4-ø14	9
32	1¼"		150	140	100	4-ø18	11
40	1½"		150	150	110	4-ø18	12
50	2"		200	165	125	4-ø18	14
65	2½"		200	185	145	8-ø18	19
80	3"		200	200	160	8-ø18	19
100	4"	1.6	250	220	180	8-ø18	24
125	5"		250	250	210	8-ø18	26
150	6"		300	285	240	8-ø22	37
200	8"	1.0	350	340	295	8-ø22	47
250	10"		400	395	350	12-ø22	86
300	12"		500	445	400	12-ø22	104
350	14"		500	505	460	16-ø22	125
400	16"		600	565	515	16-ø26	149
450	18"		600	615	565	20-ø26	214
500	20"		600	670	620	20-ø26	231
600	24"		600	780	725	20-ø30	254
700	28"		700	895	840	24-ø30	354
800	32"		800	1015	950	24-ø33	464
900	36"		900	1115	1050	28-ø33	560

יונייטד מכשור בע"מ מד זרימה מגנטי 70 – UIL

DN (mm)	min flow m ³ /h	commonly used full-range selection
10	0.08	0.16, 0.2, 0.25, 0.3, 0.4, 0.5, 0.6, 0.8, 1.0, 1.2, 1.6, 2.0, 2.5
15	0.2	0.4, 0.5, 0.6, 0.8, 1.0, 1.2, 1.6, 2.0, 2.5, 3.0, 4.0, 5.0, 6.0
20	0.3	0.6, 0.8, 1.0, 1.2, 1.6, 2.0, 2.5, 3.0, 4.0, 5.0, 6.0, 8.0, 10.0
25	0.5	1.0, 1.2, 1.6, 2.0, 2.5, 3.0, 4.0, 5.0, 6.0, 8.0, 10.0, 12.0, 14.0, 16.0
32	0.8	1.6, 2.0, 2.5, 3.0, 4.0, 5.0, 6.0, 8.0, 10.0, 12, 16, 20, 25
40	1.2	2.5, 3.0, 4.0, 5.0, 6.0, 8.0, 10.0, 12, 16, 20, 25, 30, 40
50	2	4.0, 5.0, 6.0, 8.0, 10, 12, 16, 20, 25, 30, 40, 50, 60, 70
65	3.5	6.0, 8.0, 10, 12, 16, 20, 25, 30, 40, 50, 60, 80, 100, 120
80	5	10, 12, 16, 20, 25, 30, 40, 50, 60, 80, 100, 120, 160
100	8	16, 20, 25, 30, 40, 50, 60, 80, 100, 120, 160, 200, 250
125	12	25, 30, 40, 50, 60, 80, 100, 120, 160, 200, 250, 300, 400
150	18	40, 50, 60, 80, 100, 120, 160, 200, 250, 300, 400, 500, 600
200	30	60, 80, 100, 120, 160, 200, 250, 300, 400, 500, 600, 800, 1000
250	50	100, 120, 160, 200, 250, 300, 400, 500, 600, 800, 1000, 1200, 1600
300	70	160, 200, 250, 300, 400, 500, 600, 800, 1000, 1200, 1600, 2000, 2500
350	100	200, 250, 300, 400, 500, 600, 800, 1000, 1200, 1600, 2000, 2500, 3000
400	120	250, 300, 400, 500, 600, 800, 1000, 1200, 1600, 2000, 2500, 3000, 4000
450	160	300, 400, 500, 600, 800, 1000, 1200, 1600, 2000, 2500, 3000, 4000, 5000
500	200	400, 500, 600, 800, 1000, 1200, 1600, 2000, 2500, 3000, 4000, 5000, 6000
600	300	600, 800, 1000, 1200, 1600, 2000, 2500, 3000, 4000, 5000, 6000, 10000
700	400	800, 1000, 1200, 1600, 2000, 2500, 3000, 4000, 5000, 6000, 10000, 12000
800	500	1000, 1200, 1600, 2000, 2500, 3000, 4000, 5000, 6000, 10000, 12000, 16000
900	650	1200, 1600, 2000, 2500, 3000, 4000, 5000, 6000, 8000, 10000, 12000, 16000, 18000